

版次	变更内容	审核	日期

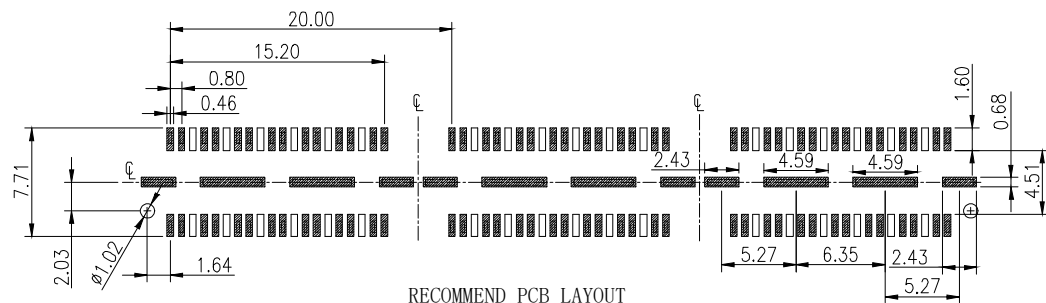

RECOMMEND PCB LAYOUT  
TOLERANCE: ±0.05

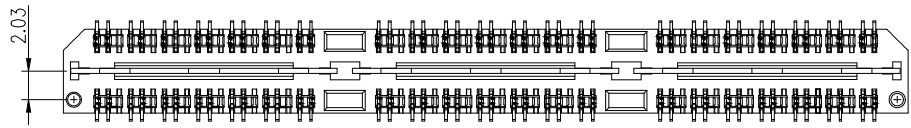
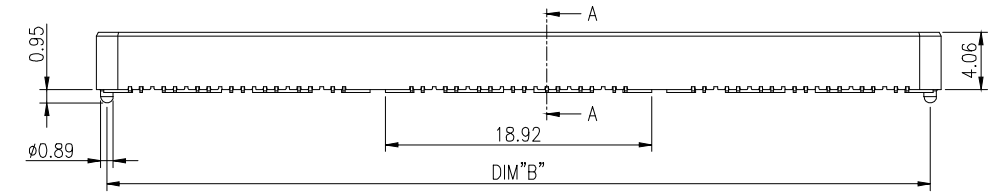
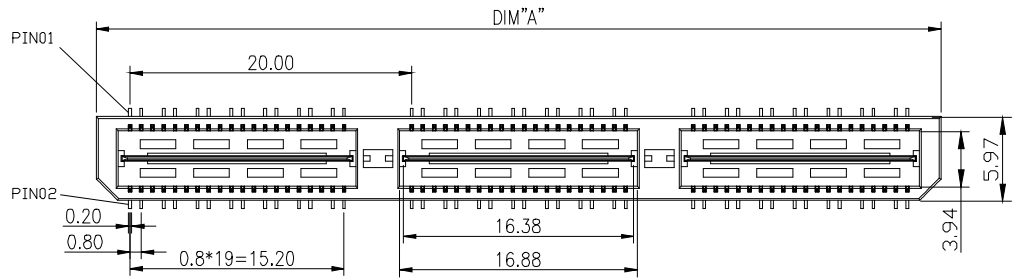
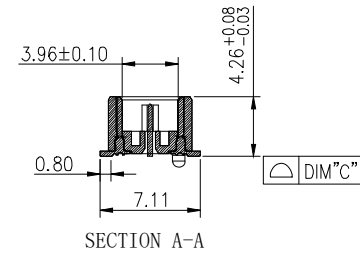
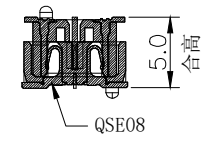

- 产品特性:
1. 绝缘体: LCP, UL 94V-0, 颜色: 黑色
  2. 端子: 磷青铜
  3. 电镀: 接触区镀金
  4. 额定电流: 2 A (2个引脚供电)
  5. 工作温度: -55° C TO +125° C
  6. 额定电压: 225V AC

QTE08-SM-2\*xxP X-DP

单排芯数: \_\_\_\_\_  
接触电镀: \_\_\_\_\_  
5G: 镀金 5u"  
10G: 镀金 10u"  
30G: 镀金 30u"

NO. OF contacts	Dimensions		
	A	B	C
2*14	20.00	18.48	0.10
2*28	40.00	38.48	0.10
2*42	60.00	58.48	0.15
2*56	80.00	78.48	0.15
2*70	100.00	98.48	0.15

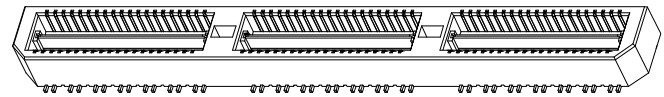

公差:	版次:	A	上海宗进电子科技有限公司		
. X ±0.35	比例:		Shanghai Zong Jin Electron Technology Co.LTD		
. XX ±0.25	单位:	mm	型号: QTE08-SM-2*xxPX-DP	签名	日期
. XXX ±2°	页码:	1/1	描述: 0.5mm BTB 高速接地插头	绘图:	
LNLB	图号:			确认:	
				审核:	